

EpiShuttle®

Treatment without compromise

ACCESSORIES, SPARE PARTS AND CONSUMABLES

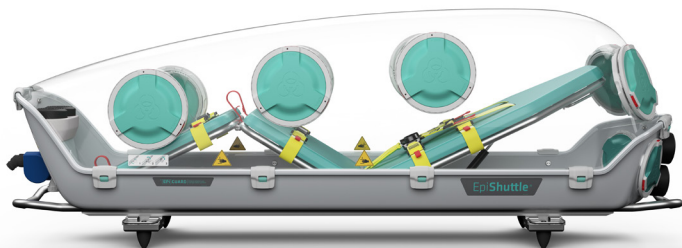

Accessories, Spare parts and Consumables

INDEX

1 EPISHUTTLE

AS01 EPISHUTTLE

2 ACCESSORIES:

AS44 MEDICAL RACK ASSEMBLY

AS15 STRETCHER ADAPTER SW

AS14 STRETCHER ADAPTER F

AS33 STRETCHER ADAPTER S

AS30 POSITIVE PRESSURE

AS04 RATCHET STRAPS

3 CONSUMABLE KITS:

KIT01 DISPOSABLE KIT

KIT02 FILTER KIT

KIT03 MATTRESS KIT

KIT04 BATTERY POWER KIT (EU) - KIT47 (UK), KIT 48 (US)

KIT05 EMERGENCY KIT

KIT06 EPIPORT 150 KIT

KIT07 WIREPORT - EPIPORT 150

KIT08 SLEEVE KIT - EPIPORT 150

KIT09 SLEEVE LID KIT - EPIPORT 150

KIT10 EPIPORT 200 KIT
KIT11 GLOVE KIT - EPIPORT 200
KIT13 SLUICE KIT - EPIPORT 200
KIT14 SLUICE BAG LID KIT - EPIPORT 200
KIT49 CHANGE BAG KIT - EPIPORT 200
KIT15 TOP COVER SEAL KIT
KIT16 PROTECTIVE SHEET KIT
KIT18 SUPPLEMENTAL BLOWER KIT
KIT19 QUICK LOCK SET

4 SPARE PARTS:

KIT20 TOP COVER REPLACEMENT
KIT21 BOTTOM COVER REPLACEMENT
KIT22 SUN SHADE
KIT23 STORAGE COVER
KIT24 SAFETY BELT SET
KIT25 SAFETY BELT FASTENER SET
KIT26 HINGE LOCK SET
KIT27 SCREW WITH COIN SLOT SET
KIT28 FASTENER SET
KIT29 DISINFECTION SET FOR BLOWER
KIT30 BOOT ASSEMBLY KIT
KIT31 ACCESSORY MANUALS KIT
KIT32 MANUALS SE KIT
KIT33 MANUALS ES KIT

1 EPISHUTTLE

AS01 EPISHUTTLE

AS01 EPISHUTTLE

Description

A complete and ready to use EpiShuttle, including printed Instructions for Use, Quick Guide, and Assembly Manual.

Parts - Overview

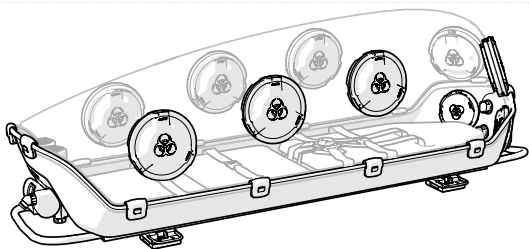

1x CleanAIR® Chemical 2F Blower with spare battery



4x A2P3 Filters



1x EpiPort 200 access port (Sluice bag)



7x EpiPort 200 access ports (Gloves)



1x EpiPort 150 access port (Ventilator sleeve)



1x EpiPort 150 access port (Medical port)



Each EpiShuttle is also delivered with a white sun shade, a black storage cover, protective sheets, batteries, chargers, sanitation plugs, change bag, luer lock adapter and vibration shock absorption mounts not pictured.

2 ACCESSORIES

AS44 MEDICAL RACK

AS15 STRETCHER ADAPTER SW

AS14 STRETCHER ADAPTER F

AS33 STRETCHER ADAPTER S

AS30 POSITIVE PRESSURE

AS04 RATCHET STRAPS

AS44 MEDICAL RACK

Description

A 10 x 25 mm rail on which to mount monitors, medical pumps, ventilators and other medical equipment to the base. Holds up to 5 kg.

Parts - Overview

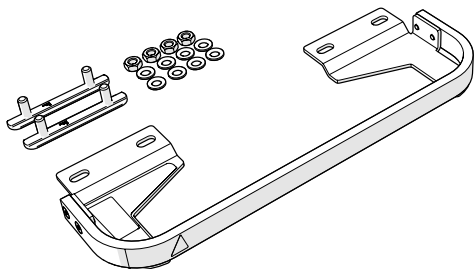

1x AS44 Medical Rack

AS15 STRETCHER ADAPTER SW

Description

Ensures that the EpiShuttle can be quickly and safely secured to Stollenwerk 4002, 4003, 4002-1 stretchers.

2

Parts - Overview

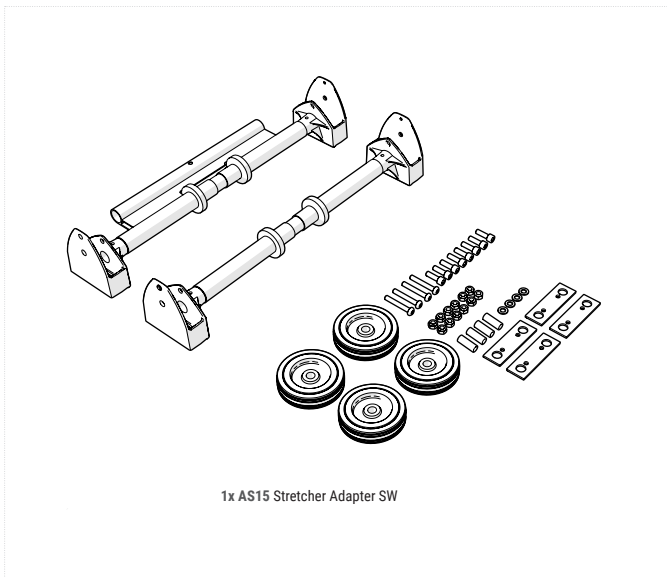

AS14 STRETCHER ADAPTER F

Description

Ensures that the EpiShuttle can be quickly and safely secured to Ferno Mondial ST-70 stretchers.

Parts - Overview

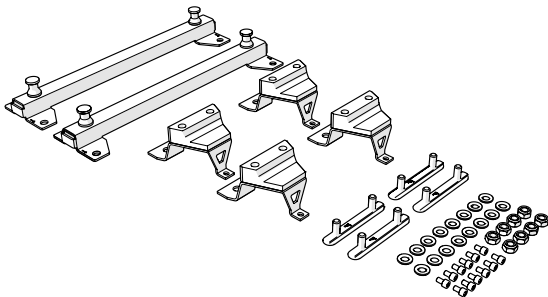

1x AS14 Stretcher Adapter F

AS33 STRETCHER ADAPTER S

Description

Ensures that the EpiShuttle can be quickly and safely secured to Stryker M1 stretchers.

2

Parts - Overview

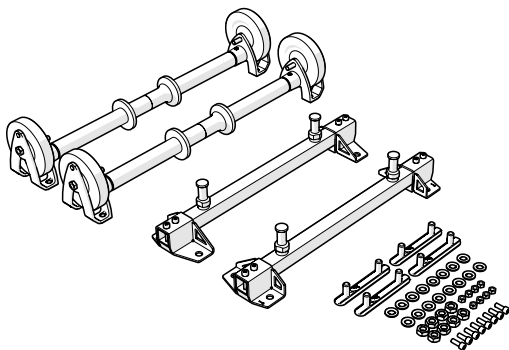

1x AS33 Stretcher Adapter S

AS30 POSITIVE PRESSURE

Description

Components and instructions required to operate the EpiShuttle in positive pressure mode, which is used to protect a vulnerable patient from the outside environment.

Parts - Overview

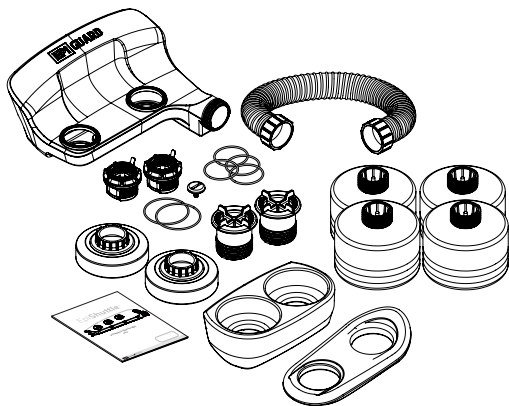

1x AS30 Positive pressure

AS04 RATCHET STRAPS

Description

Ensures that the EpiShuttle can be quickly and safely secured to a wide variety of stretcher undercarriages. The set includes specific instructions to secure the EpiShuttle to Ferno Harrier, Ferno Pegasus, Ferno Megabus, and the Stryker PowerPro, in addition to generic instructions for installation on other stretchers with suitable structural elements. The EpiShuttle Ratchet Straps are suitable for use in road ambulances and in aviation applications.

Parts - Overview

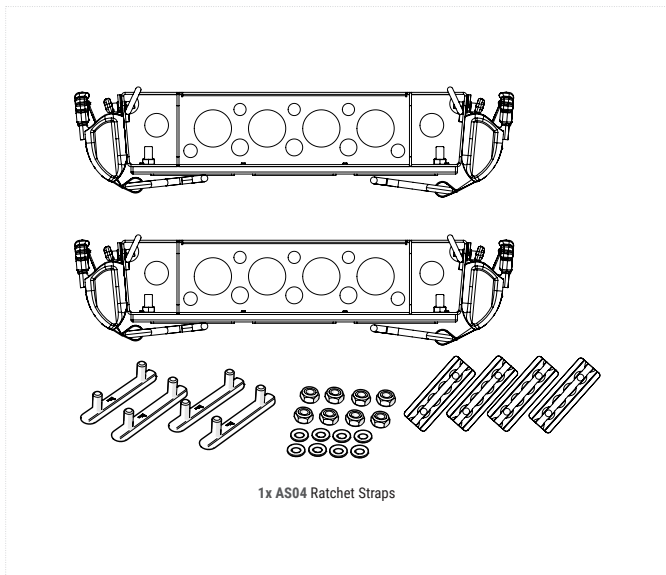

3 CONSUMABLES

KIT01 DISPOSABLE KIT

KIT02 FILTER KIT

KIT03 MATTRESS KIT

KIT04 BATTERY POWER KIT

KIT05 EMERGENCY KIT

KIT06 EPIPORT 150 KIT

KIT07 WIREPORT KIT - EPIPORT 150

KIT08 SLEEVE KIT - EPIPORT 150

KIT09 SLEEVE LID KIT - EPIPORT 150

KIT10 EPIPORT 200 KIT

KIT11 GLOVE KIT - EPIPORT 200

KIT13 SLUICE KIT - EPIPORT 200

KIT14 SLUICE BAG LID KIT - EPIPORT 200

KIT49 CHANGE BAG KIT - EPIPORT 200

KIT15 TOP COVER SEAL KIT

KIT16 PROTECTIVE SHEET KIT

KIT01 DISPOSABLE KIT

Description

Kit including all parts that must be replaced as part of the full decontamination procedure after transport of a highly contagious patient. This kit includes filters, mattresses, gaskets, and more.

3

Parts - Overview

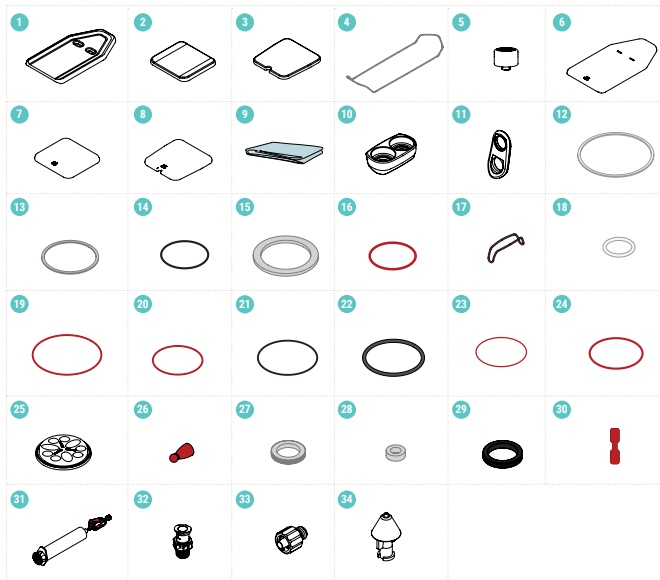

Parts list

Item Nr	Part Nr	Part Name	PCS
1	CP46	Mattress - Back rest	1
2	CP45	Mattress - Thigh	1
3	CP44	Mattress - Calf	1
4	GS09	Seal 11,7 x 20,8mm x 5500mm	1
5	SP06	A2P3 Filter Ø115	4
6	CP61	Sheet mattress - Back rest	1
7	CP60	Sheet mattress - Thigh	1
8	CP59	Sheet mattress - Calf	1
9	CP47	Protective sheet	1
10	CP49	Filter Foam Support	1
11	CP63	Filter Foam Head	1
12	GS02	Epiport 200 - Flat seal 4 x 8 ID233	8
13	GS04	Epiport 150 - Flat seal 4 x 8mm ID170	2
14	GS05	O-ring 42x2	8
15	GS06	Valve - Flat seal 3x7 ID 47	4
16	GS10	Epiport 150 - End lid seallock 90x5	1
17	GS11	Epiport 150 - Rubber band 74x3	2
18	GS14	O - ring 24x3	10
19	GS18	O - ring Ø3 x cutlength 690mm	24
20	GS19	O - ring Ø3 x cutlength 495mm	6
21	GS20	O - ring 55x1,5	2
22	GS21	Rubber band 52x3	16
23	GS23	O - ring 115x3	1
24	GS24	O - ring 110x5	1
25	CP13	Epiport 150 - Wireport	1
26	CP15	Epiport 150 - Wireport plug	9
27	GS12	Epiport 150 - End lid seal Ø22mm	1
28	GS25	Gasket L-track belt bracket	10
29	GS07	Valve - CleanAir Sealing	4
30	CP58	Valve - Tape	4
31	AS35	Luer lock adapter	1
32	SP21	Female Luer - SFTLL-1	1
33	SP20	Male Luer - SMTLL-1	1
34	SP29	Atomization device	1

KIT02 FILTER KIT

Description

Kit including a complete set of four A2P3 filters and the foam support brackets in which they are mounted.

3

Parts - Overview

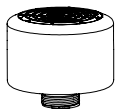

4x SP06 A2P3 Filter Ø115

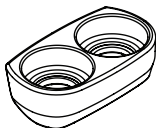

1x CP49 Filter Foam Support



1x CP63 FILTER SUPPORT - Head

KIT03 MATTRESS KIT

Description

Kit including a complete set of three mattresses and sheets for the back rest, thigh and calf. These should be replaced between patient transport for hygienic reasons and to reduce risk of infection.

Parts - Overview

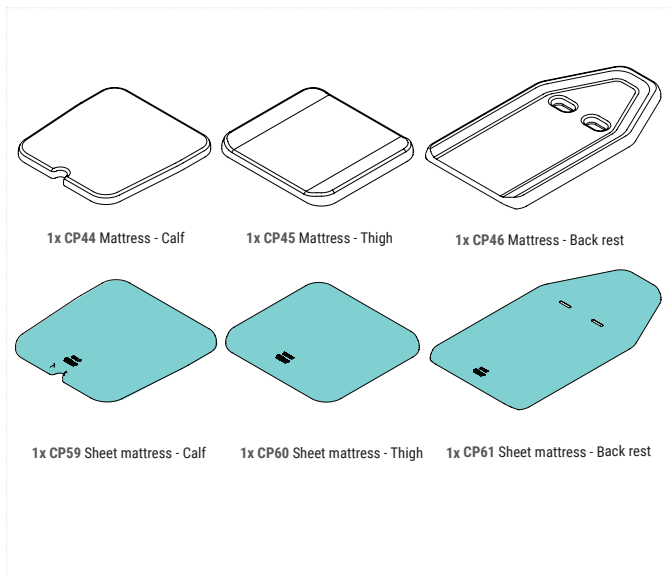

KIT04 BATTERY POWER KIT (EU) - KIT47 (UK), KIT 48 (US)

Description

Kit including one charger and two batteries for the CleanAir Chemical 2F blower. These can either be used as a replacement or back-up for the charger and batteries included in the EpiShuttle (AS01) as standard.

3

Parts - Overview



2x SP11 CleanAir Chemical 2F Plus – Battery

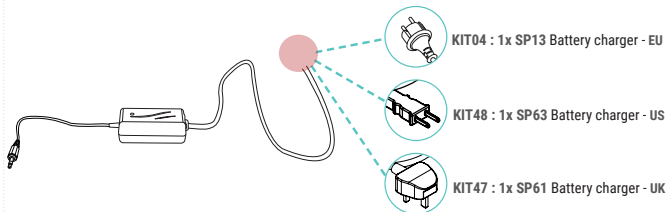

KIT05 EMERGENCY KIT

Description

Kit including various components that may be required in case of unexpected events during patient transport, including two extra A2P3 filters and equipment to replace a torn glove. Contents are packed in a convenient EpiGuard-branded travel bag with straps and handles.

Parts - Overview

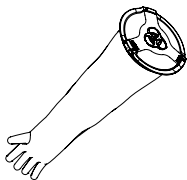

1x AS13 Glove Kit

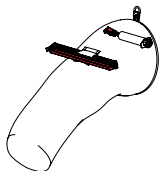

1x AS23 Change Bag

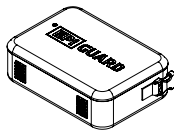

1x SP17 Bag Emergency Kit



2x SP06 A2P3 Filter Ø115



2x GS18 O - ring Ø3 x Cutlength 690mm

KIT06 EPIPORT 150 KIT

Description

Kit including one complete set of inner and outer lids, and all rings, seals, gaskets and three red hinge locks for the 150 mm ports in the head end of the Bottom Cover. The ports can be combined with either the EpiPort 150 - Wireport Kit (KIT07) or EpiPort 150 Sleeve Kit (KIT08), which must be bought separately.

3

Parts - Overview



1x CP08 EpiPort 150 - Outer Lock Ring



1x CP16 EpiPort 150 - Inner Lock Ring



1x CP12 EpiPort 150 - Mount Ring



2x CP09 EpiPort 150 - Lid



3x CP17 EpiPort - Hinge Lock



3x GS19 O-ring Ø3 x cutlength 495mm



1x GS04 EpiPort 150 - Flat seal 4x 8 ID 170

KIT07 WIREPORT KIT - EPIPORT 150

Description

Kit including one EpiPort 150 Wireport (CP13) and nine red Wireport Plugs (CP15). The wireport permits secure passage of IV lines, monitoring cables, or oxygen lines into the EpiShuttle. The wireport is not reusable and therefore included in the EpiShuttle Disposable Kit (KIT01). The wireport should also be replaced before being used for patient transport if it has previously been used in training sessions.

Parts - Overview

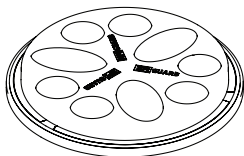

1x CP13 EpiPort 150 Wireport



9x CP15 EpiPort 150 Wireport Plug

KIT08 SLEEVE KIT - EPIPORT 150

Description

Kit including one EpiPort 150 - Sleeve (CP10), a flexible and transparent sleeve for the entry of mechanical ventilator hose. The sleeve is reusable if not damaged during patient transport. The shelf life is 42 months from production and should be replaced when expired.

3

Parts - Overview

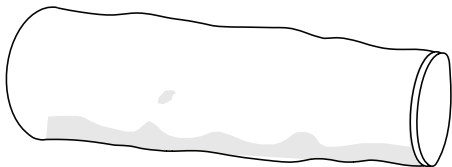

1x CP10 Epiport 150 - Sleeve

KIT09 SLEEVE LID KIT - EPIPORT 150

Description

Kit including lid, seals, and rubber bands to hold the filter in place in the EpiPort 150 - Sleeve.

Parts - Overview

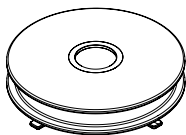

1x CP11 EpiPort 150 - Sleeve End Lid



1x GS12 End lid seal $\varnothing 22\text{mm}$



1x GS10 End lid seallock 90x5



2x GS11 Rubber band 74x3

KIT10 EPIPORT 200 KIT

Description

Kit including one complete set of inner and outer lids, and all rings, seals, gaskets and three red hinge locks for the 200 mm ports in the Top Cover. The ports can be combined with either the EpiPort 200 - Glove Kit (KIT11), EpiPort 200, or EpiPort 200 Sluice Kit (KIT13), which must be bought separately.

Parts - Overview

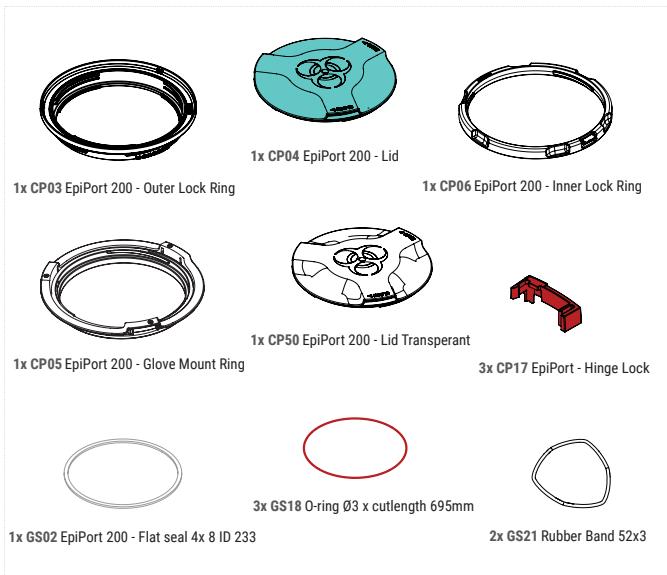

KIT11 GLOVE KIT - EPIPORT 200

Description

Kit including one EpiPort 200 - Glove (SP03), an ambidextrous glove made from flame-resistant CSM/Hypalon, compliant with European regulation 2016/ 425, PPE Category 3, and tested according to EN 374-1, EN 374-5, and EN 388. The gloves are reusable if not damaged during patient transport. The shelf life is 42 months from production and should be replaced when expired.

Parts - Overview

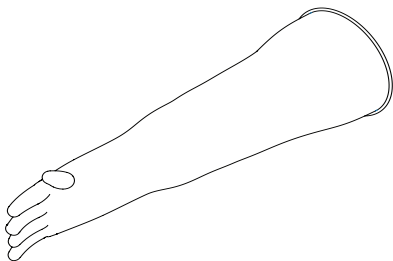

1x SP03 Glove - EpiPort 200

KIT13 SLUICE KIT - EPIPORT 200

Description

Kit including one EpiPort 200 - Sluice Bag (CP43), which is used to transfer equipment, food or medicine to the patient during transport. The sluice bag is reusable if not damaged during patient transport. The shelf life is 42 months from production and should be replaced when expired. Note that the kit does not include the lid.

Parts - Overview

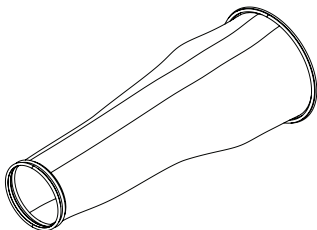

1x CP43 Sluice Bag - EpiPort 200

KIT14 SLUICE BAG LID KIT - EPIPORT 200

Description

Kit including lid and mount for the EpiPort 200 – Sluice Bag (CP43), plus the atomization device and luer lock adapter used to disinfect the sluice bag during transport. Gaskets are included to ensure a sealed assembly at all times.

Parts - Overview

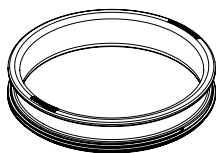

1x CP55 Sluice Bag - End lid Mount

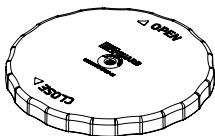

1x CP56 Sluice Bag - End lid



1x GS23 O - ring 115x3

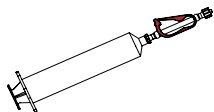

1x AS35 Luer lock adapter



1x SP29 Atomization Device



1x GS24 O - ring 110x5

KIT49 CHANGE BAG KIT - EPIPORT 200

Description

Kit including a new change bag, which is used for safe replacement of damaged gloves during patient transport. The kit also includes a plastic lock and syringe, luer, and atomization device.

3

Parts - Overview

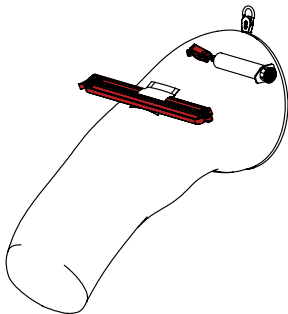

1x AS23 Change Bag

KIT15 TOP COVER SEAL KIT

Description

Kit including one Seal 11,7 x 20,8mm L 5500mm (GS09), which ensures an airtight seal between the Top Cover and Bottom Cover.

Parts - Overview

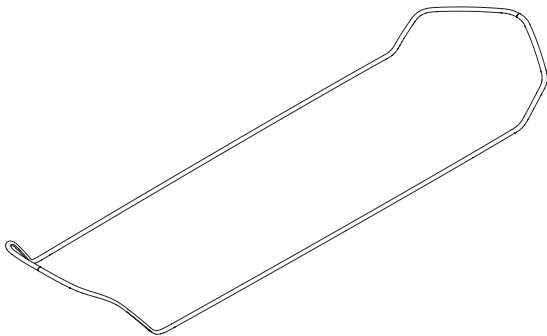

1x GS09 Seal 11,7 x 20,8mm L 5500mm

KIT16 PROTECTIVE SHEET KIT

Description

A box of 6 highly absorbent sheets (140 cm x 245 cm) for loading patients in EpiShuttle and absorbing fluid spills.

3

Parts - Overview

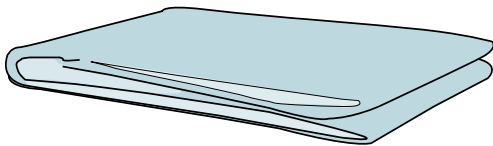

6x CP47 Protective sheet

4 SPARE PARTS

- KIT18 SUPPLEMENTAL BLOWER KIT
- KIT19 QUICK LOCK SET
- KIT20 TOP COVER REPLACEMENT
- KIT21 BOTTOM COVER REPLACEMENT
- KIT22 SUN SHADE
- KIT23 STORAGE COVER
- KIT24 SAFETY BELT SET
- KIT25 SAFETY BELT FASTENER SET
- KIT26 HINGE LOCK SET
- KIT27 SCREW WITH COIN SLOT SET
- KIT28 FASTENER SET
- KIT29 DISINFECTION SET FOR BLOWER
- KIT30 BOOT ASSEMBLY KIT
- KIT31 ACCESSORIE MANUALS KIT
- KIT32 - KIT40 EPISHUTTLE MANUALS
- KIT41 EPISHUTTLE TRAINING KIT
- KIT42 GASKET KIT
- KIT43 MANIFOLD KIT
- KIT44 BED FRAME KIT

KIT18 SUPPLEMENTAL BLOWER KIT

Description

Kit including one Clean Air chemical blower, a particle filter and a flexi hose, creates a backup system in case the blower installed in the EpiShuttle, fails. The blower ensures a filtered air flow through the EpiShuttle.

Parts - Overview

4

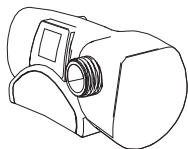

1x SP05 CleanAir Chemical 2F Plus



1x SP09 P3 Filter Ø115 - Particle Filter

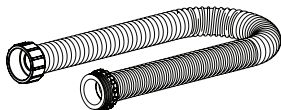

1x SP57 Light flexi hose

KIT19 QUICK LOCK SET

Description

A kit including parts to replace the locking clip mechanical system, in case of failure in any of the below shown parts.

Parts - Overview

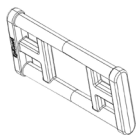

1x CP39 Locking clip - Hinge



1x CP40 Locking clip - Handle

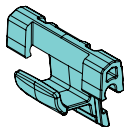

1x CP41 Locking clip - Bracket



1x CP64 Screw with coin slot M5 x 10mm

KIT20 TOP COVER REPLACEMENT

Description

This kit offers a replacement Top Cover with necessary labeling.

Parts - Overview

4

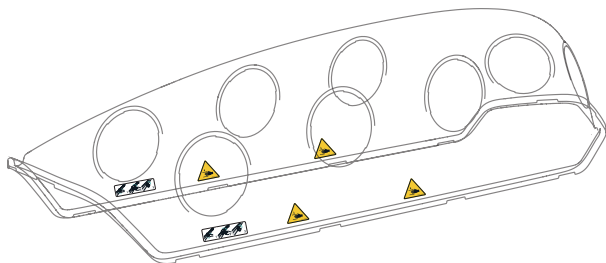

1x CP01 Top Cover

Labels:

2x AW04 Decal Open Guide

4x AW05 Decal Pinch Point

KIT21 BOTTOM COVER REPLACEMENT

Description

This kit offers a replacement bottom cover with necessary labeling.

Parts - Overview

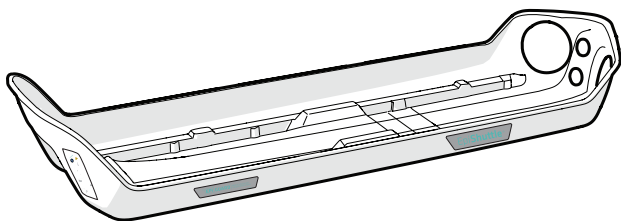

1x CP02 Bottom cover

Labels:

1x AW01 Decal Overview

2x AW02 Decal EpiGuard Logo Side

2x AW03 Decal EpiShuttle Logo Side

1x AW06 Decal Battery Change Guide

KIT22 SUN SHADE

Description

The sunshade is used to minimize the effects of direct sunlight while a patient is inside the EpiShuttle. This kit offers an extra or a replacement sunshade.

Parts - Overview

4

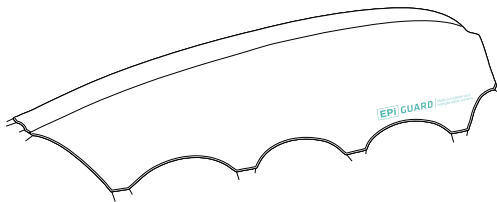

1x CP54 Sun Shade

KIT23 STORAGE COVER

Description

The storage cover offers protection for the EpiShuttle while it is not in use. It has a pocket to store the instructions for use near the foot end.

Parts - Overview



1x CP62 Storage Cover

KIT24 SAFETY BELT SET

Description

The Safety belts are used to secure patients inside the EpiShuttle during transport. This kit contains one 6-point belt (SP04) and three 2-point belts (SP10).

Parts - Overview

4

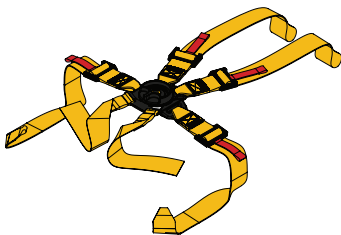

1x SP04 Belts 6POINTS, yellow



3x SP10 Belts 2pt chest, yellow

KIT25 SAFETY BELT FASTENER SET

Description

Belt nuts are used to fasten the belts to the structure of the EpiShuttle. This kit includes belt nuts and associated gaskets.

Parts - Overview

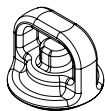

10x CP32 Belt Nut



10x GS14 O-ring 24x3



10x GS25 Gasket L-track belt bracket

KIT26 HINGE LOCK SET

Description

The Hinge Locks are used to secure the attachment of EpiPorts to the EpiShuttle.

Parts - Overview

4



30x CP17 EpiPort - Hinge lock

KIT27 SCREW WITH COIN SLOT SET

Description

The Screw with coin slots is used to secure the EpiShuttle Quick locks to the bottom cover. One screw with coin slot is used to mount the Manifold to the bottom cover.

Parts - Overview



13x CP64 Screw with coin slot M5 x 10mm

KIT28 FASTENER SET

Description

The EpiShuttle Fastener Set is used to assemble the bottom framework. Fasteners for assembly of the Manifold are also included.

Parts - Overview

4

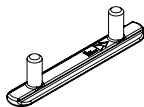

4x FA06 T-bolt 2-pin

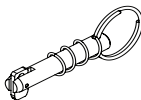

5x CP51 Latch pin



10x FA05 T-bolt 1-pin



26x FA08 Washer, Flat, DIN125A



1x FA10 M10x1.0 for Actuator



12x FA16 Screw, Hex socket head cap



8x FA07 Lock nut, Hex, DIN985 - M10

KIT29 DISINFECTION SET FOR BLOWER

Description

Sanitation plugs are used to cover the filter openings during soak disinfection, the cork is used to cover the front opening of the blower.

Parts - Overview

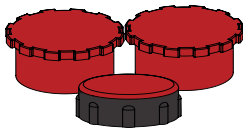

1xSP25 Sanitation plug

KIT30 BOOT ASSEMBLY KIT

Description

This kit contains the metal chassis of the EpiShuttle, along with vibration dampers for use in air transport.

Parts - Overview

4

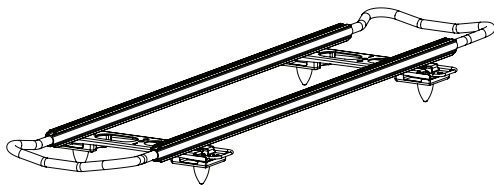

1x AS26 Boot Assembly

- 4x FA06 L-tracks - TN3
- 8x FA07 Lock nut, Hex, DIN985 - M10
- 16x FA08 Washer, Flat, DIN125A - ISO7089 - M10
- 1x FA16 Hex socket head cap screw M6 x 10 DIN912 ISO4762
- 1x AS07 L-tracks
- 4x AS48 Sole pad bootbracket with insert
- 4x SP44 Vibration Shock Absorption Mounts - GN453 -50-68-M10-S-55
- 2x SM07 Boot bracket

KIT31 ACCESSORY MANUALS KIT

Description

Instructions for use are essential to operate the EpiShuttle and its accessories. This kit contains the English instructions for operating the Positive pressure kit, the medical rack and stretcher adapters.

Parts - Overview



1x UG04 Positive Pressure IFU



1x UG05 Medical Rack IFU



1x UG39 Ratchet Straps IFU



1x UG06 Stretcher Adapters IFU

KIT32 TO KIT40 - MANUALS KIT SE/I/CZ/ FI/FR/EN/DE

Description

EpiShuttle comes with two manuals. Instructions for use is a detailed user manual and a reference for operators. The assembly manual is an active document used to keep track of disinfection cycles and detail the disassembly/assembly process. They are available in several languages.

Parts - Overview

4

KIT32 EpiShuttle Manuals SE Kit

- 1x UG30 Instruction for use SE
- 1x UG37 Assembly Manual SE

KIT33 EpiShuttle Manuals ES Kit

- 1x UG16 Instruction for use ES
- 1x UG17 Assembly Manual ES

KIT34 EpiShuttle Manuals DK Kit

- 1x UG32 Instruction for use DK
- 1x UG33 Assembly Manual DK

KIT35 EpiShuttle Manuals I Kit

- 1x UG25 Instruction for use I
- 1x UG26 Assembly Manual I

KIT36 EpiShuttle Manuals CZ Kit

- 1x UG22 EpiShuttle Instructions for Use - CZ
- 1x UG23 EpiShuttle Assembly Manual - CZ

KIT37 EpiShuttle Manuals FI Kit

- 1x UG19 EpiShuttle Instructions for Use - FI
- 1x UG20 EpiShuttle Assembly Manual - FI

KIT38 EpiShuttle Manuals FR Kit

- 1x UG13 Instruction for use FR
- 1x UG14 Assembly Manual FR

KIT39 EpiShuttle Manuals EN Kit

- 1x UG01 Instruction for use
- 1x UG02 Assembly Manual

KIT40 EpiShuttle Manuals DE KIT

- 1x UG10 Instructions for Use - DE
- 1x UG11 Assembly Manual - DE

KIT41 TRAINING KIT

Description

This kit includes a complete set of parts to be fitted to the EpiShuttle prior to a training session. By using and reusing this kit, original parts intended for actual patient transports will not get worn or damaged during training. This ensures that preparedness is maintained.

Parts - Overview

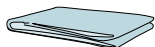

1x CP47 Protective sheet

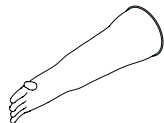

7x KIT11 EpiPort 200 - Glove Kit



1x KIT14 EpiPort 200 - Sluice Bag Lid Kit



10x KIT07 EpiPort 150 - Wireport Kit



1x KIT02 EpiShuttle Filter Kit



2x KIT06 EpiShuttle EpiPort 150 Kit

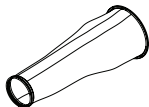

1x KIT13 EpiPort 200 - Sluce Bag Kit



8x KIT10 EpiShuttle EpiPort 200 Kit



1x KIT09 EpiPort 150 - Sleeve Lid Kit



1x KIT08 EpiPort 150 - Sleeve Kit



1x KIT29 Disinfection Set for Blower

KIT42 GASKET KIT

Description

This kit contains a complete set of all gaskets used in the EpiShuttle, except the main Seal (GS09).

Parts - Overview

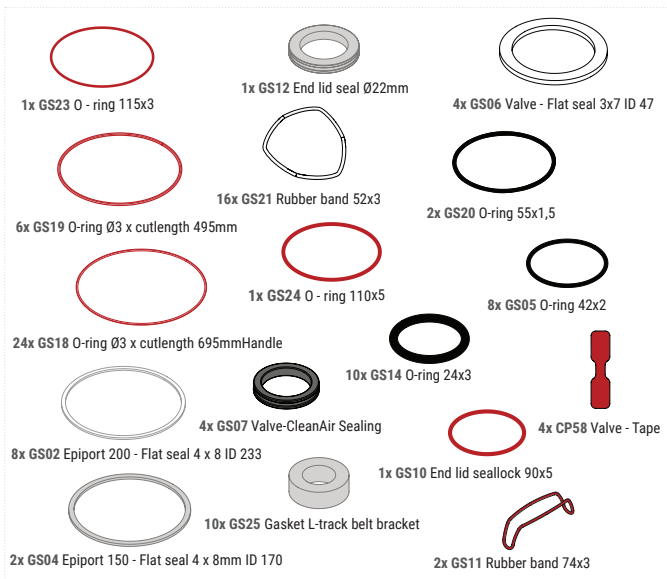

KIT43 MANIFOLD KIT

Description

The manifold is the assembly in which the pump is connected to the EpiShuttle. It forms a valved airway between the outside and the inside of the EpiShuttle. This kit offers the negative pressure mode configuration of the manifold.

Parts - Overview

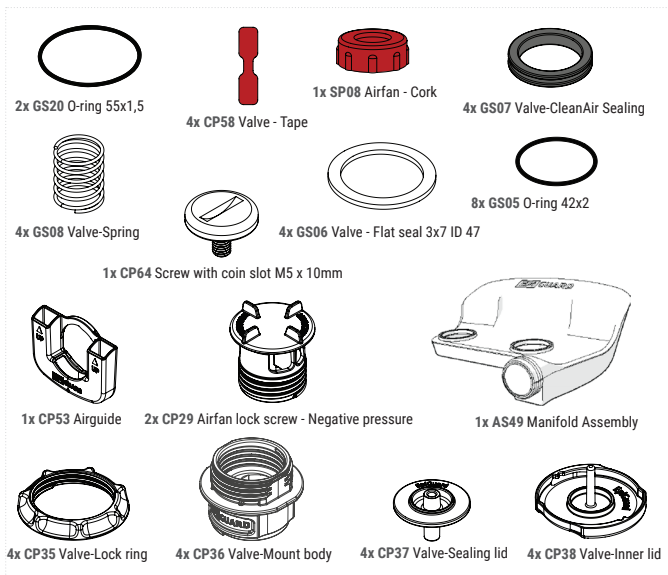

KIT44 BED FRAME KIT

Description

This kit contains the bed frame assembly inside the EpiShuttle, including the actuator system for the back rest.

Parts - Overview

4

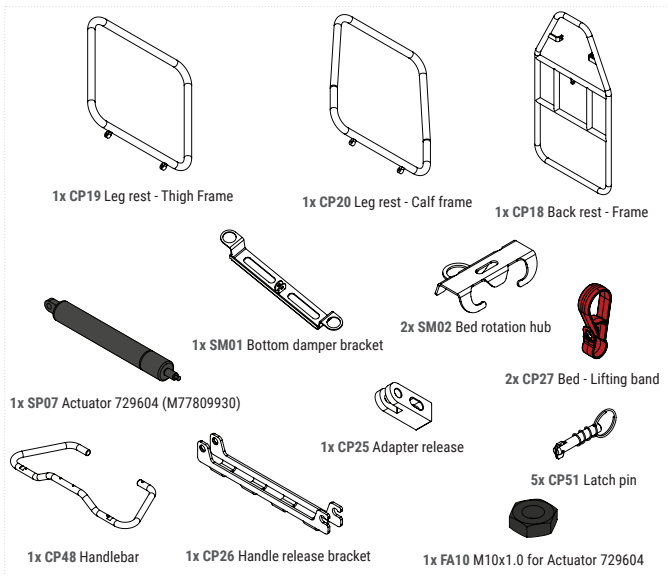

Manufacturer, Main Office

EPIGUARD AS
Torsnesveien 210B
1634 Gamle Fredrikstad
Norway
info@epiguard.com

www.epiguard.com